

PAPPILAN PALSTOITUSALUE

yli 3000 m²:n asuntotontteja

x vapaana 4 kpl 0,84 e/m²

2/2 3058 m²

2/3 3033 m²

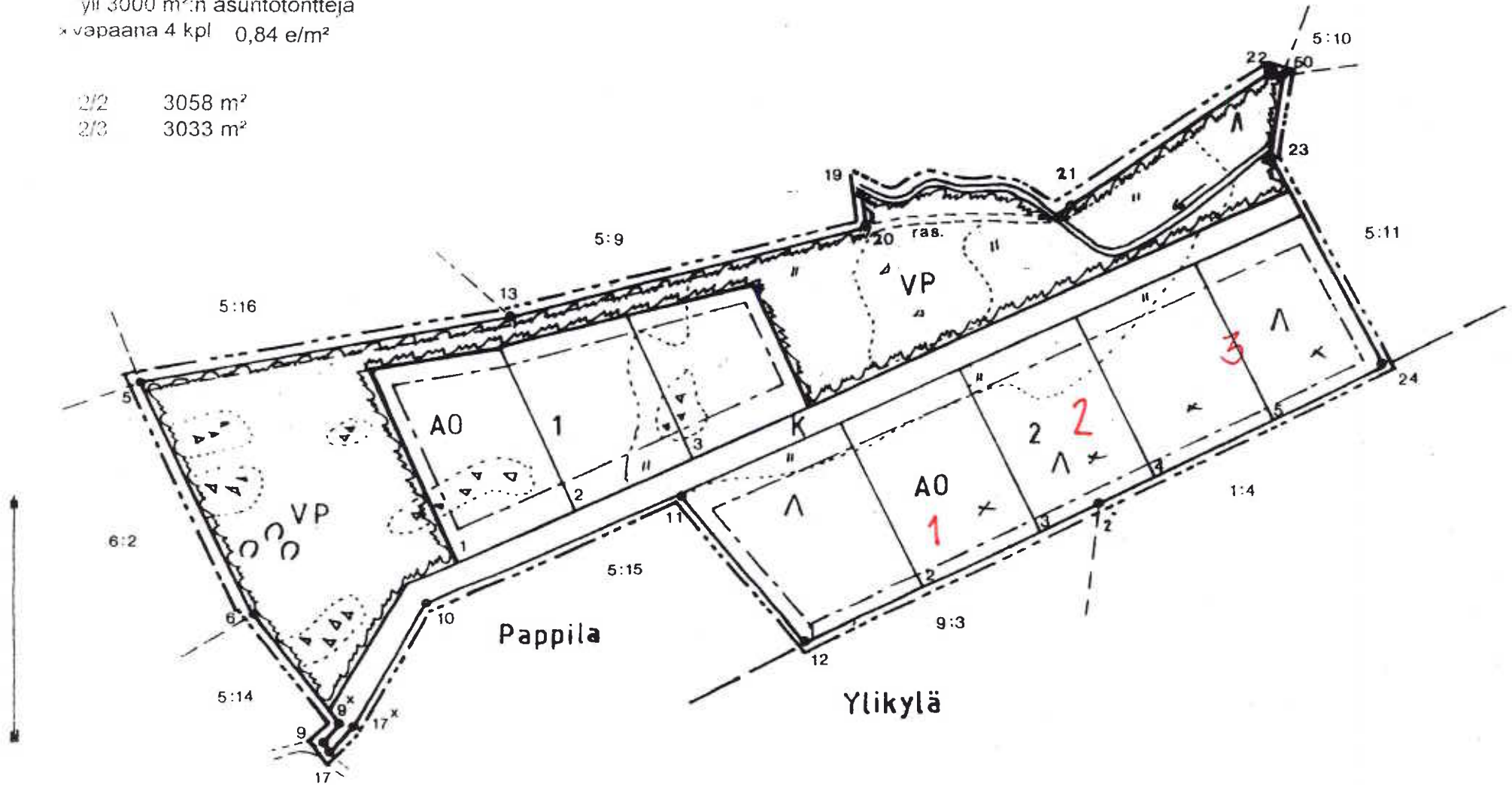







1:2000

PYHÄRANTA

PAPPILAN ALUE

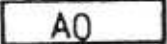
MERKINTÖJEN SELITYKSET

	3 m sen alueen ulkopuolella oleva viiva, jolle palstoitus suunnitelma on laadittu.
	Korttelin raja.
	Ohjeellinen rakennuspaikan raja.
2	Korttelin numero.
4	Rakennuspaikan numero.
	Rakennusala.
	Enintään kaksiasuntoisten asuinrakennusten korttelialue.
	Puistoalue.
	Katualue.

Raumalla 28.8.1930.

Markku Airaksinen
Dipl.ins.